

LEAD FORMING TYPE

Type	Part Number	Dimensions (mm)																											
		φD	F	ℓ	L (Part number for lead length and pitch for taping)																±0.1								
					Z	2	B	E	G	M	T	3	C	D	4	5	6	7	I	8		J	9	K	A	L	H	Q	S
					2.0	2.5	2.8	3.1	3.3	3.5	3.8	3.5	3.8	4.0	4.5	5.0	6.3	7.0	7.5	8.0		8.5	9.0	9.5	10	10.5	12	23	26
±0.2				±0.3	±0.5																								
Cutting	C	4	1.5	---																	FIG1								
		5	2.0	---																									
		6.3	2.5	---																									
		8	3.5	---																									
		10	5.0	---																									
		13	5.0	---																									
		16	7.5	---																									
		18	7.5	---																									
Kink & Cutting	B	4	5.0	1.1																	FIG2								
		5	5.0	1.1																									
		6.3	5.0	1.1																									
		8	5.0	1.3																									
		10	5.0	1.3																									
		13	5.0	1.3																									
		16	7.5	1.3																									
		18	7.5	1.3																									
		Forming & Cutting	D	8	2.5	----																	FIG3						
			F	4	5.0	----																	FIG4						
5	5.0			----																									
6.3	5.0			----																									
8	5.0		----																										
H	13		7.5	----																	FIG5								

LEAD FORMING TYPE

Type	Part Number	Dimensions (mm)																												
		φD	F	ℓ	L (Part number for lead length and pitch for taping)																									
					Z	2	B	E	G	M	T	3	C	D	4	5	6	7	I	8	J	9	K	A	L	H	Q	S		
					2.0	2.5	2.8	3.1	3.3	3.5	3.8	3.5	3.8	4.0	4.5	5.0	6.3	7.0	7.5	8.0	8.5	9.0	9.5	10	10.5	12	23	26		
					±0.2			±0.3		±0.5																±0.1				
Forming & Cutting	L	5	2.0	2.5																									FIG6	
		6.3	2.5	2.5																										
		8	3.5	2.5																										
		10	5.0	2.5																										
		13	5.0	2.5																										
		16	7.5	2.5																										
		18	7.5	2.5																										
	T	5	2.0	1.5																									FIG7	
		6.3	2.5	1.5																										
		8	3.5	1.5																										
		10	5.0	1.5																										
		13	5.0	1.5																										
		16	7.5	1.5																										
		18	7.5	1.5																										
	R	5	2.0	1.5																									FIG8	
		6.3	2.5	1.5																										
		8	3.5	1.5																										
		10	5.0	1.5																										
		13	5.0	1.5																										
		16	7.5	1.5																										
		18	7.5	1.5																										
	S	5	2.0	2.5																									FIG9	
		6.3	2.5	2.5																										
		8	3.5	2.5																										
		10	5.0	2.5																										
		13	5.0	2.5																										
		16	7.5	2.5																										
		18	7.5	2.5																										
G	5	2.0	---																									FIG10		
	6.3	2.5	---																											
	8	3.5	---																											
	10	5.0	---																											
	13	5.0	---																											
	16	7.5	---																											
	18	7.5	---																											
E	5	2.0	---																									FIG11		
	6.3	2.5	---																											
	8	3.5	---																											
	10	5.0	---																											
	13	5.0	---																											
	16	7.5	---																											
	18	7.5	---																											

TAPING

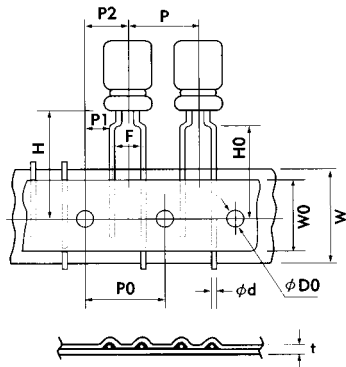

FIG 12- I

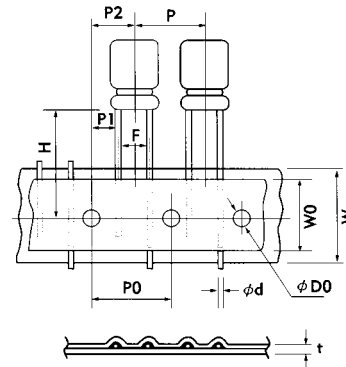

FIG 12- II

Item	Symbol	Tolerance	Formed Lead Type (12- I)						
			ϕ 4x5 ϕ 4x7	ϕ 5x5 ϕ 5x7	ϕ 6.3x5	ϕ 6.3x7	ϕ 5x11 ϕ 6.3x11	ϕ 8x5 ϕ 8x7 ϕ 8x9	ϕ 8x12 ϕ 8x16 ϕ 8x20
Lead wire diameter	ϕ d	± 0.05	0.45	0.45	0.45	0.45	0.5	0.45/0.5	0.6
Pitch of component	P	± 1.0	12.7	12.7	12.7	12.7	12.7	12.7	12.7
Feed hole pitch	P0	± 0.2	12.7	12.7	12.7	12.7	12.7	12.7	12.7
Hole center to lead	P1	± 0.5	3.85	3.85	3.85	3.85	3.85	3.85	3.85
Feed hole center to component	P2	± 1.0	6.35	6.35	6.35	6.35	6.35	6.35	6.35
Lead-to-lead distance	F	+0.8/-0.2	5.0	5.0	5.0	5.0	5.0	5.0	5.0
Height of component from tape center	H	± 0.5	18.5	18.5	18.5	18.5	18.5	18.5	18.5
Lead wire clinch height	H0	± 0.5	16.0	16.0	16.0	16.0	16.0	16.0	16.0
Tape width	W	± 0.5	18.0	18.0	18.0	18.0	18.0	18.0	18.0
Hole down tape width	W0	Min	12.5	12.5	12.5	12.5	12.5	12.5	12.5
Feed hole diameter	ϕ D0	± 0.2	4.0	4.0	4.0	4.0	4.0	4.0	4.0
Total tape thickness	t	± 0.2	0.7	0.7	0.7	0.7	0.7	0.7	0.7

Item	Symbol	Tolerance	Formed Lead Type (12- II)							
			ϕ 4	ϕ 5	ϕ 6.3	ϕ 8	ϕ 10	ϕ 13	ϕ 16	ϕ 18
Lead wire diameter	ϕ d	± 0.05	0.45	0.5	0.5	0.6	0.6	0.6	0.8	0.8
Pitch of component	P	± 1.0	12.7	12.7	12.7	12.7	12.7	15.0	30.0	30.0
Feed hole pitch	P0	± 0.2	12.7	12.7	12.7	12.7	12.7	15.0	15.0	15.0
Hole center to lead	P1	± 0.5	5.6	5.35	5.1	4.6	3.85	5.0	3.75	3.75
Feed hole center to component	P2	± 1.0	6.35	6.35	6.35	6.35	6.35	7.5	7.5	7.5
Lead-to-lead distance	F	+0.8/-0.2	1.5	2.0	2.5	3.5	5.0	5.0	7.5	7.5
Height of component from tape center	H	± 0.5	18.5	18.5	18.5	18.5	18.5	18.5	18.5	18.5
Tape width	W	± 0.5	18.0	18.0	18.0	18.0	18.0	18.0	18.0	18.0
Hole down tape width	W0	Min	12.5	12.5	12.5	12.5	12.5	12.5	12.5	12.5
Feed hole diameter	ϕ D0	± 0.2	4.0	4.0	4.0	4.0	4.0	4.0	4.0	4.0
Total tape thickness	t	± 0.2	0.7	0.7	0.7	0.7	0.7	0.7	0.7	0.7

Available Terminals For Snap-In Type (Unit:mm)

<p>D=30 to 35mm</p>	<p>Sleeve</p> <p>Vent</p> <p>$\phi D+1max.$</p> <p>$L\pm 2$</p> <p>4.5 ± 1</p> <p>PC board pin-out</p> <p>$2-1.2\times 6$</p> <p>4.2 ± 0.5</p> <p>5 ± 0.5</p> <p>14.2 ± 1</p>
<p>D=22 to 35 mm</p>	<p>Sleeve</p> <p>Vent</p> <p>$\phi D+1max.$</p> <p>$L\pm 2$</p> <p>5.5 ± 0.5</p> <p>PC board pin-out</p> <p>10</p> <p>$2-\phi 2$</p>
<p>D=35 to 40mm</p>	<p>Sleeve</p> <p>Vent</p> <p>$\phi D+1max.$</p> <p>$L\pm 2$</p> <p>5.5 ± 0.5</p> <p>PC board pin-out</p> <p>60°</p> <p>60°</p> <p>22.5</p> <p>$4-\phi 2$</p> <p>Terminal B=positive Terminal A & C=blank</p>
<p>D=40 mm</p>	<p>Sleeve</p> <p>Vent</p> <p>$\phi 40+1max.$</p> <p>$L\pm 2$</p> <p>6.5 ± 1</p> <p>PC board pin-out</p> <p>10</p> <p>10</p> <p>10.4</p> <p>3.3</p> <p>7.7</p> <p>7.1</p> <p>2.5</p> <p>10</p> <p>Terminal C=positive Terminal A, B & D=blank</p>
<p>D=20x25 to 61mm, D=25x31 to 61mm</p>	<p>Sleeve</p> <p>Vent</p> <p>$\phi D+1max.$</p> <p>$L\pm 2$</p> <p>4 ± 1</p> <p>Negative mark</p> <p>1.5 ± 0.1</p> <p>8 ± 1</p>